

QLDC disposal from 516 Ladies Mile

LAND REQUIRED FOR EASEMENT					
REF No.	ID	AREA (Ha)	LEGAL DESCRIPTION	OWNER	OPERATIVE AND PROPOSED DISTRICT PLAN ZONING
LM2a		0.007	LOT 1 DP 531988 (RT 884963)	QUEENSTOWN COUNTRY CLUB VILLAGE LIMITED	RURAL (BUILDING RESTRICTION AREA)
LM2b		0.007	LOT 1 DP 531988 (RT 884963)	QUEENSTOWN COUNTRY CLUB VILLAGE LIMITED	RURAL (BUILDING RESTRICTION AREA)
LM2c		0.007	LOT 1 DP 531988 (RT 884963)	QUEENSTOWN COUNTRY CLUB VILLAGE LIMITED	RURAL (BUILDING RESTRICTION AREA)
LM2d		0.011	LOT 1 DP 531988 (RT 884963)	QUEENSTOWN COUNTRY CLUB VILLAGE LIMITED	RURAL (BUILDING RESTRICTION AREA)

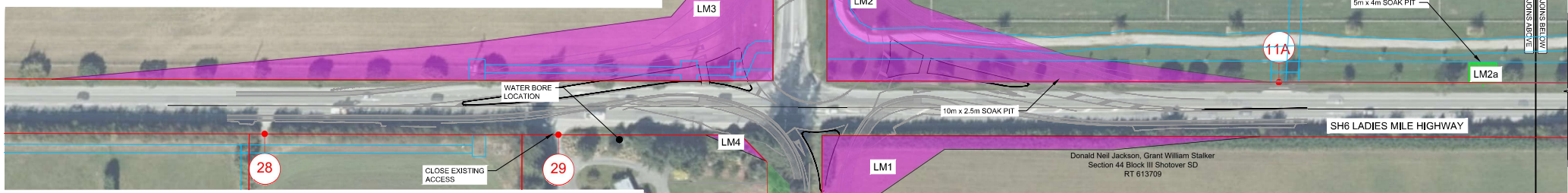

LAND REQUIRED FOR ROAD / STATE HIGHWAY					
REF No.	ID	AREA (Ha)	LEGAL DESCRIPTION	OWNER	OPERATIVE AND PROPOSED DISTRICT PLAN ZONING
LM1		0.133	SECTION 43 BLOCK III SHOTOVER SD (RT 613709) SECTION 44 BLOCK III SHOTOVER SD (RT 613709)	DONALD WILLIAM BENNET, GRANT WILLIAM STALKER	RURAL LIFESTYLE (BUILDING RESTRICTION AREA)
LM2		0.283	LOT 1 DP 531988 (RT 884963)	QUEENSTOWN COUNTRY CLUB VILLAGE LIMITED	RURAL (BUILDING RESTRICTION AREA)
LM3		0.407	LOT 4 DP 22156 (RT 889403) LOT 1 DP 536321 (RT 889403)	QUEENSTOWN LAKES DISTRICT COUNCIL	RURAL LIFESTYLE (BUILDING RESTRICTION AREA)
LM4		0.006	LOT 1 DP 12822 (OT5C/21)	KERI PARANAHIA LEMAIRE-SICRE, ROLAND GILBERT FERNAND CHARLES LEMAIRE-SICRE	RURAL LIFESTYLE (BUILDING RESTRICTION AREA)

LAND REQUIRED FOR LOCAL ROAD					
REF No.	ID	AREA (Ha)	LEGAL DESCRIPTION	OWNER	OPERATIVE AND PROPOSED DISTRICT PLAN ZONING
LM5		0.063	SECTION 44 BLOCK III SHOTVER SD (RT 613709)	DONALD WILLIAM BENNET, GRANT WILLIAM STALKER	RURAL LIFESTYLE (BUILDING RESTRICTION AREA)
LM7		0.008	LOT 4 DP 22156 (RT 889403) LOT 1 DP 536321 (RT 889403)	QUEENSTOWN LAKES DISTRICT COUNCIL	RURAL LIFESTYLE (BUILDING RESTRICTION AREA)
LM8		0.037	LOT 1 DP 531988 (RT 884963)	QUEENSTOWN COUNTRY CLUB VILLAGE LIMITED	RURAL (PART BUILDING RESTRICTION AREA)

LOCAL ROAD PROPOSED TO BE STOPPED FOR EXCHANGE PURPOSES					
REF No.	ID	AREA (Ha)	ADJOINING	OWNER	OPERATIVE AND PROPOSED DISTRICT PLAN ZONING
LM6		0.053	LOT 1 DP 12822 (OT5C/21)	KERI PARANAHIA LEMAIRE-SICRE, ROLAND GILBERT FERNAND CHARLES LEMAIRE-SICRE	UNFORMED ROAD

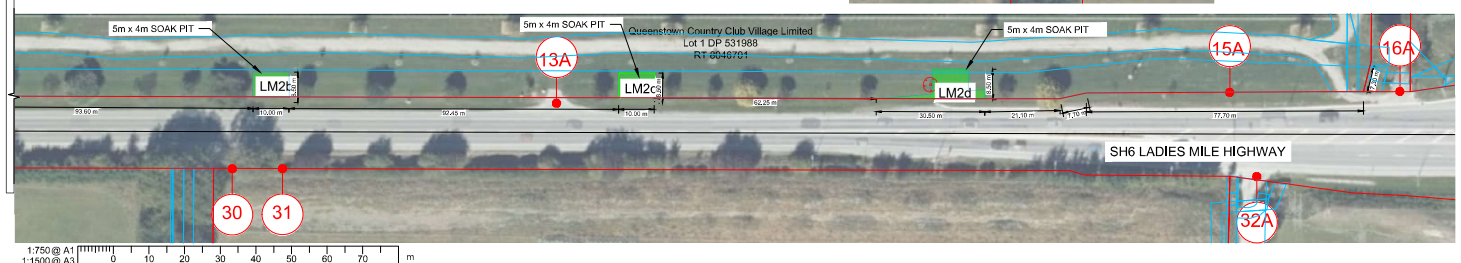

- LEGEND
- 1 LIMITED ACCESS ROADING AUTHORISED CROSSING PLACE SH8 HAYES TO FRANKTON
  - 2 LIMITED ACCESS ROADING AUTHORISED CROSSING PLACE SH8 LAKE HAYES TO FRANKTON
  - EXISTING EASEMENTS
  - EXTENT OF EARTHWORKS

APPROVED BY REGIONAL MANAGER - CENTRAL AND LOWER SOUTH ISLAND, INFRASTRUCTURE DELIVERY

DATE: \_\_\_\_\_

NOT FOR CONSTRUCTION

REVISION	AMENDMENT	APPROVED	DATE
A	ISSUED FOR CONSULTATION	R.G.	23/08/2021
B	ISSUED FOR CONSULTATION. REVISED DRAINAGE EASEMENTS	R.G.	5/10/2021
C	LAND REQUIRED FOR ROAD UPDATED	R.G.	28/06/2022
D	LAND REQUIRED FOR NORTH LEG HAS BEEN UPDATED	R.G.	4/07/2022
E	LAND REQUIRED FOR ROAD UPDATED	R.G.	12/07/2022
F	LEGEND, NOTES AND LAND AREA UPDATED	R.G.	27/07/2022
G	PARCEL BOUNDARY AND NOTES UPDATED	R.G.	01/08/2022



SCALES			ORIGINAL SIZE
1:750			A1
DRAWN	DESIGNED	APPROVED	
R.ABDULLAH	T.GRANT	B.MILLS	
DRAWING VERIFIED	DESIGN VERIFIED	APPROVED DATE	
R.GIBSON	R.GIBSON	23/08/2021	

PROJECT			
NZUP QUEENSTOWN SH6 WORKS			
TITLE			
LAND REQUIREMENT OVERALL PLAN - LADIES MILE			
PROJECT NO.	PROJ/PROG/WORK/DISC/FILE	SHEET NO.	REVISION
KHT	KHT-NZU-DES-PL-DG	PL1000	G