

CLASSIFICATION	CRITERIA
HV - Highly Visible	<ul style="list-style-type: none"> - Readily visible from a specified viewpoint/viewpoints eg. SH6. - Viewing distance less than 1km - Visible for greater than 5 seconds from the road corridor (ie. distance of greater than 150m assuming a vehicle travelling at 80-100km/hr).
MV - Moderately Visible	<ul style="list-style-type: none"> - Visible or intermittently readily visible from a specified viewpoint/viewpoints. - if readily visible, then visible from the road for less than 5 seconds or 150m of the road corridor. - Viewing distance greater than 2km.
LV - Low Visibility	<ul style="list-style-type: none"> - Intermittently visible or not readily visible from a specified viewpoint/viewpoints. - Viewing distance greater than 2km.
NV - Low Visibility	<ul style="list-style-type: none"> - Cannot be seen from specified viewpoint/viewpoints.

KEY	
Study Area Boundary	
Cadastral Boundaries	
Visibility Analysis Areas	
Visibility from Lake Wakatipu mapped from viewpoints 0.5km, 1.0km, 1.5km and 2.0km from the lake edge at a height of 4m (radiating line of sight from points at 1 degree intervals).	
Visibility from State Highway 6 mapped from viewpoints 3m high along the state highway corridor. Points north of Lakeside Estates mapped at 300m intervals and south at 500m intervals.	
Visibility has been mapped with no consideration for existing vegetation (ie. existing shelter belts)	

FIGURE 10
VISIBILITY ANALYSIS
 coneburn area resource study

scale 1:30,000

july 2002

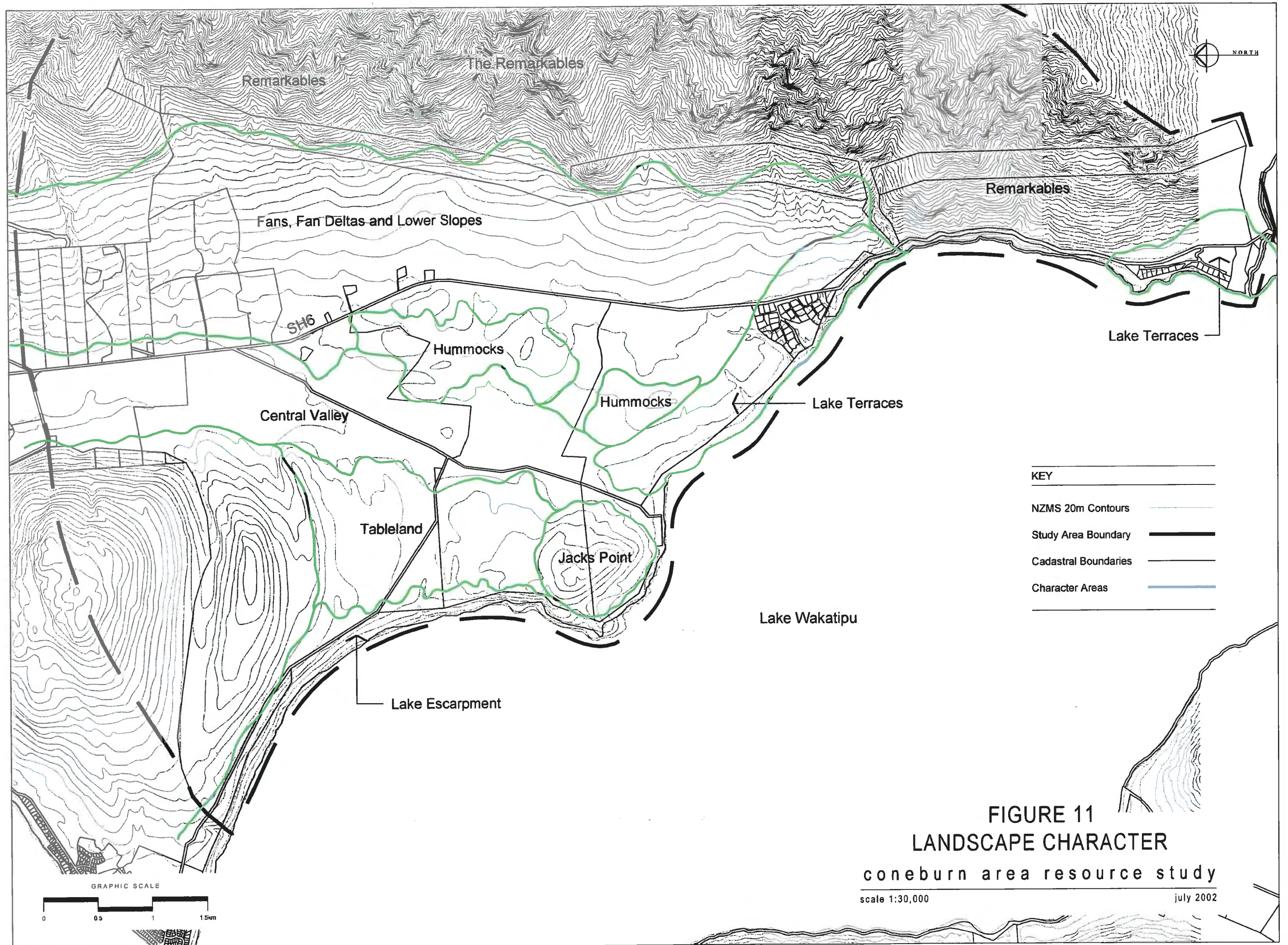
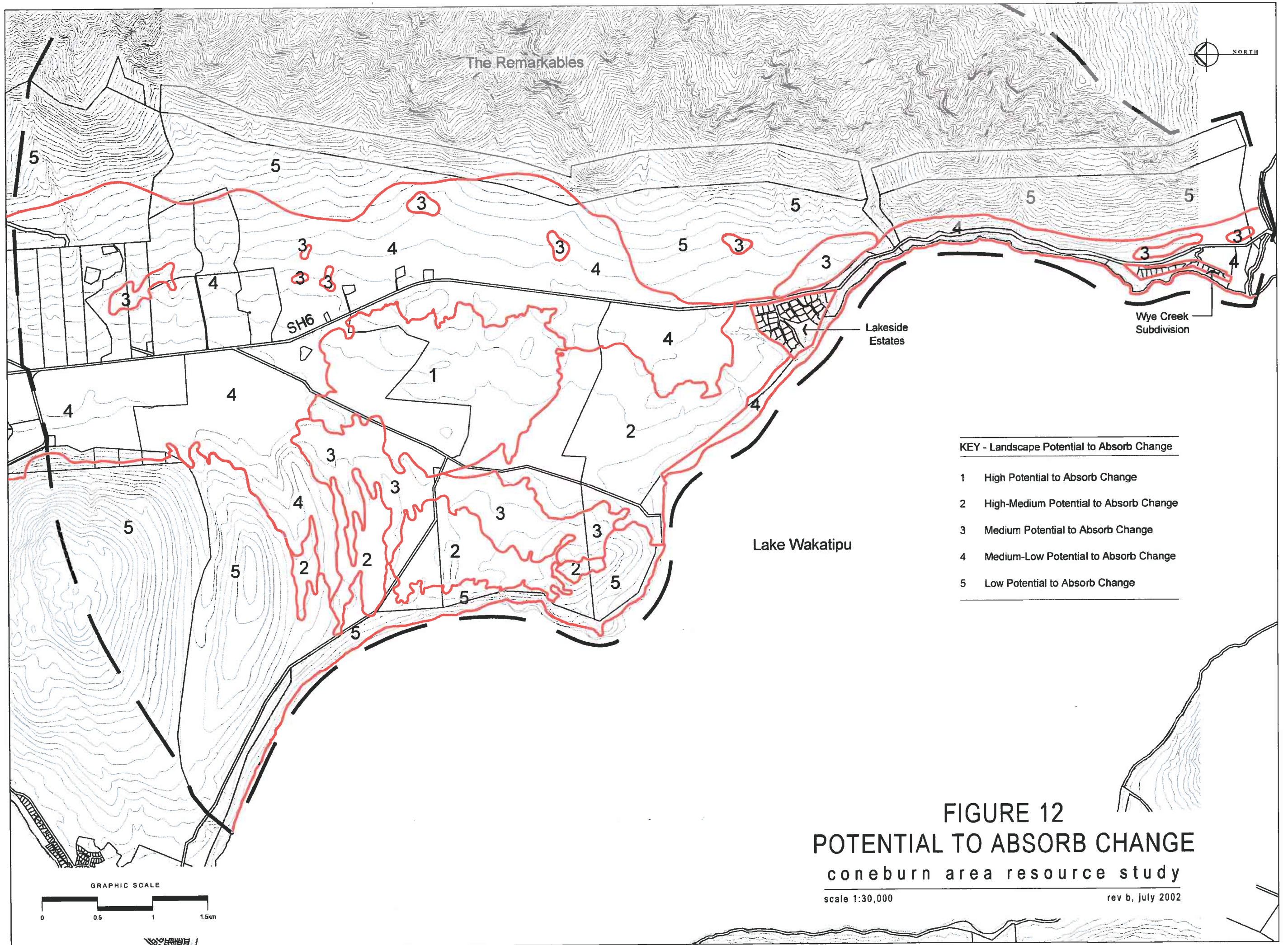

FIGURE 11
LANDSCAPE CHARACTER
 coneburn area resource study
 scale 1:30,000
 july 2002



KEY - Landscape Potential to Absorb Change

1	High Potential to Absorb Change
2	High-Medium Potential to Absorb Change
3	Medium Potential to Absorb Change
4	Medium-Low Potential to Absorb Change
5	Low Potential to Absorb Change

FIGURE 12
POTENTIAL TO ABSORB CHANGE
 coneburn area resource study
 scale 1:30,000
 rev b, july 2002

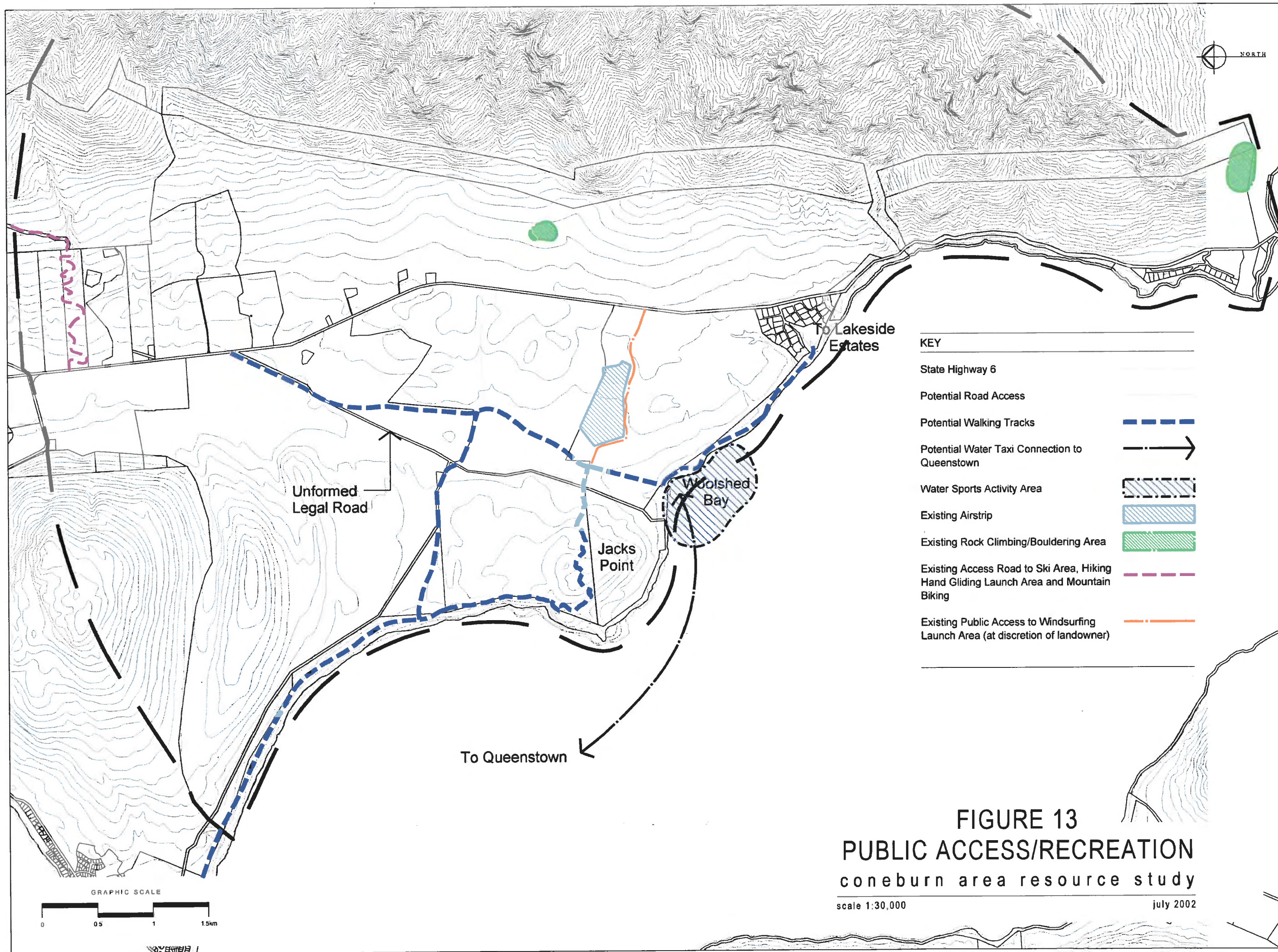
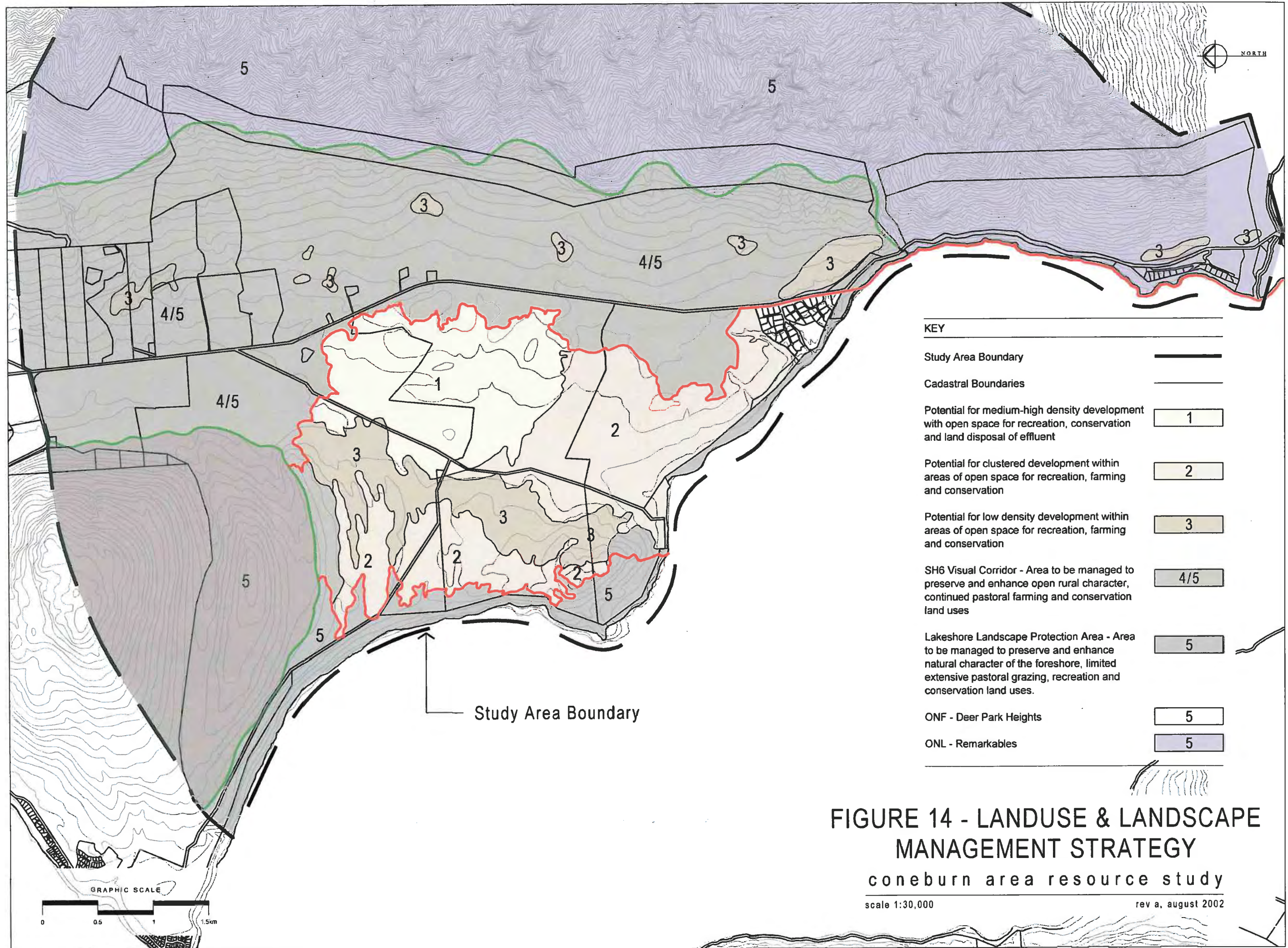

FIGURE 13
PUBLIC ACCESS/RECREATION
 coneburn area resource study

scale 1:30,000

july 2002



KEY	
Study Area Boundary	
Cadastral Boundaries	
Potential for medium-high density development with open space for recreation, conservation and land disposal of effluent	
Potential for clustered development within areas of open space for recreation, farming and conservation	
Potential for low density development within areas of open space for recreation, farming and conservation	
SH6 Visual Corridor - Area to be managed to preserve and enhance open rural character, continued pastoral farming and conservation land uses	
Lakeshore Landscape Protection Area - Area to be managed to preserve and enhance natural character of the foreshore, limited extensive pastoral grazing, recreation and conservation land uses.	
ONF - Deer Park Heights	
ONL - Remarkables	

FIGURE 14 - LANDUSE & LANDSCAPE MANAGEMENT STRATEGY
 coneburn area resource study
 scale 1:30,000 rev a, august 2002