



FOR CLIENT REVIEW 01.07.2020

Clark Fortune McDonald & Associates
 Licensed Cadastral Surveyors - Land Development - Planning Consultants
 309 Lower Shotover Road, P.O.Box 553 Queenstown
 Tel. (03)441-6044, Fax (03)442-1066, Email admin@cfma.co.nz
 Shop 2, Otago House, 475 Moray Place, P.O. Box 5960
 Tel. (03)470-1582, Fax (03)470-1583, Email admin@cfma.co.nz

Rev.	Date	Revision Details	By
A	20.07.2020	Amend consent notice boundary on lots 270-272	ED
B	17.11.2020	Amend reserve lot 302 and add dimensions	ED
C	12.07.21	Lot sizes changes	NT
C	19.01.22	Add annotations for activity areas etc for council	ED

**WOOLSHED ROAD DEVELOPMENT
 SUBDIVISION SCHEME PLAN**

Client	Surveyed	Date	Checked	Job No.	Drawing No.
HENLEY DOWNS FARM HOLDINGS LTD	-	-	-	12983	8
Notes: All dimensions shown are in meters unless shown otherwise. Any person using Clark Fortune McDonald drawings and other data accepts the risk of: - Using the drawings and other data in electronic form without requesting and checking them for accuracy against the original hard copy versions. - Ensuring the information is the most recent issue. - Copyright on this drawing is reserved.	Drawn	Date	Checked	Scale	1:1000 @ A1 1:2000 @ A3
	NT	01.07.20	-	Datum & Level	NZGD2000 / MSL
Designed	Date	Checked		Rev.	D

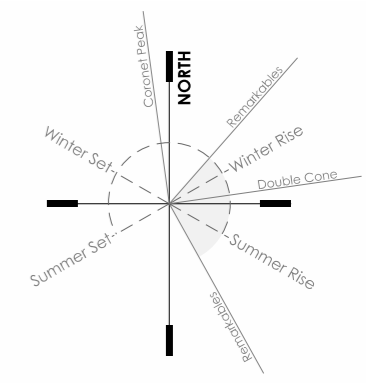

- KEY:**
- Planting covenant areas - Jacks Point Structure Plan State Highway Mitigation and OSA
 - Proposed Reserves
 - 2.5m wide cycle / pedestrian trail

SITE LANDSCAPE ARCHITECTS ^

www.sitela.co.nz . 021838855 . Queenstown

1:2000 @ A3
scale

E	05.07.21	RC
D	08.07.20	Issued for RC
C	19.06.20	Additional play equipment added
B	17.06.20	Draft for review
A	03.06.20	Draft for review
-	20.05.20	Draft for review

revisions

Woolshed Road Classic Developments
Masterplan

RC

drawing no.	revision
241_SK-001	E



KEY:

- Reserve boundary
 - A 2.5m wide cycle/pedestrian trail - crushed/compact schist chip
 - B 1.5m wide cycle/pedestrian path - crushed/compact schist chip
 - C 100mm shotover rocks to base of pond
 - D 30 x 30m open space
 - E Browntop/fescue grass
 - F Low mounding max gradient 1:3
- Refer Sheet SK-007 for plant schedule

SITE LANDSCAPE ARCHITECTS ^

www.sitela.co.nz . 021838855 . Queenstown

1:500 @ A3
scale

E 05.07.21 . RC
 D 08.07.20 . Issued for RC
 C 19.06.20 . Additional play equipment added
 B 17.06.20 . Draft for review
 A 03.06.20 . Draft for review
 - 20.05.20 . Draft for review

revisions

Woolshed Road Classic Developments
 Western Reserve: General Arrangement

RC

drawing no.	revision
241_SK-002	E

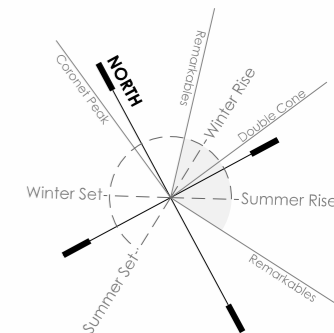

KEY:

— Reserve boundary

Refer Sheet SK-009 for typical park details
Refer Sheet SK-007 for plant schedule

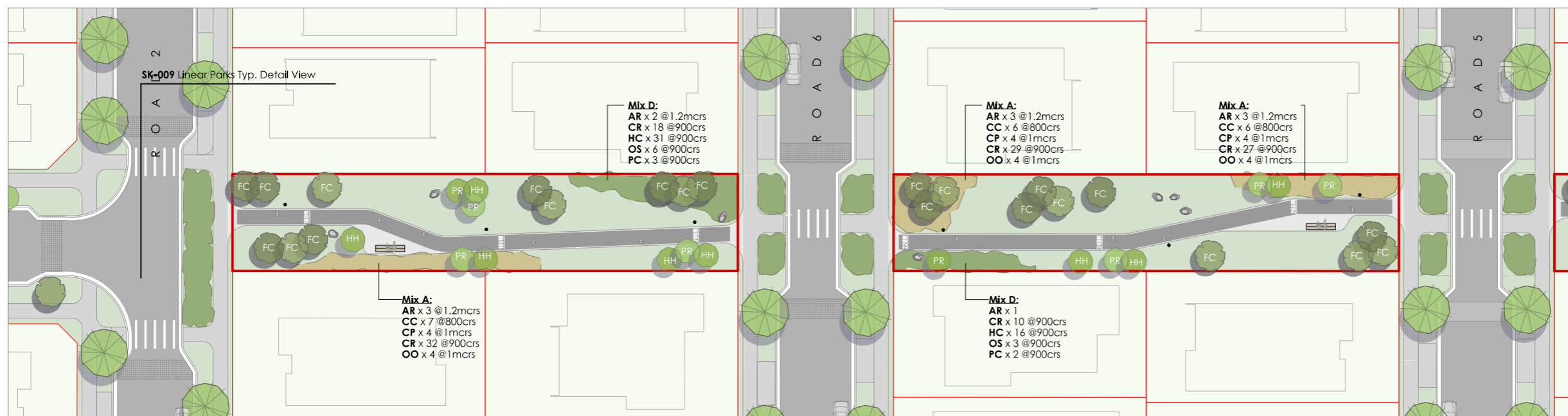

SK-004.1

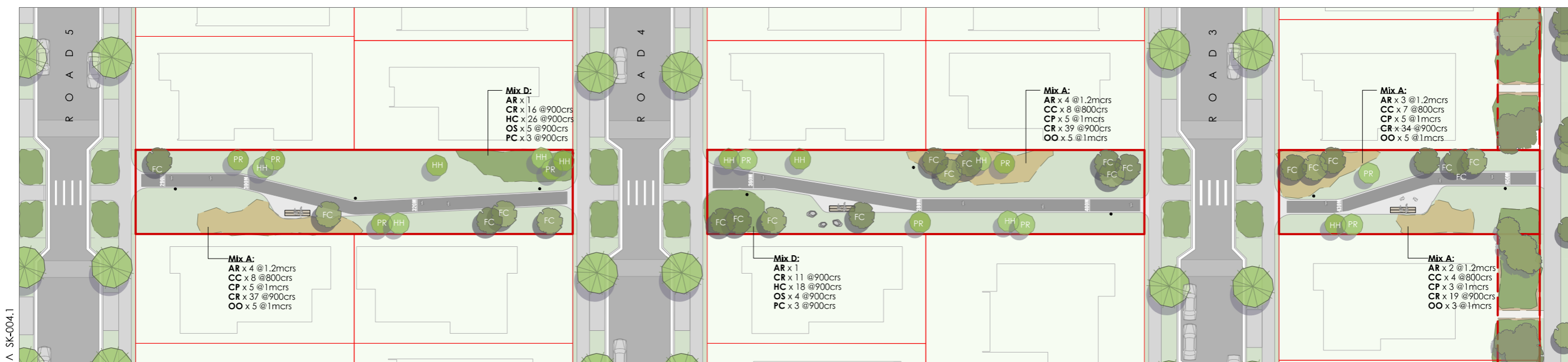

SK-004.2